

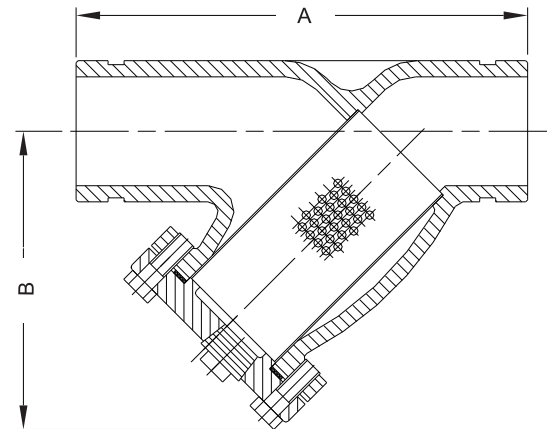

## Schematic Drawing



## Features

- 175 PSI Working Pressure
- -10° c to 120° c Working Temperature
- Internally and externally spray-painted or fusion bonded epoxy powder coated ( FBE ) .
- NPT or BSPT blowoff outlet on cover. Blowoff outlets are finished with plugs.
- Screens are perforated 304 stainless steel with spot welded seam.
- Recessed seat in body assures accurate screen alignment.
- Flanges to ANSI B16. 1 Class125 (Other types available upon Request)

## Material Specification

Component	Material
<b>Body</b>	Cast Iron ASTM A126 Class B
<b>Cover</b>	Cast Iron ASTM A126 Class B
<b>Screen</b>	Stainless Steel AISI 304
<b>Gasket</b>	PTFE/Graphite
<b>Plug</b>	Ductile Iron ASTM A536 Gr. 65-45-12

## Standard Screen

Size (mm/inch)	Hole Dia. (mm)	Free Flow Area (%)
65(2-1/2")	3	53.6
80-125(3"-5")	4	46.3
250 (10")	4.7	54.5
300(12")	6.3	57.2

## Notes:

Design and material are subject to change without notice.

## Dimensions (mm/inch)

Size	A		B		Plug Size (NPT Thread)	Weight (kg)
	mm	inch	mm	inch		
65mm/2-1/2"	273	10-3/4	135	5.3	1"	10.7
80mm/3"	295	11-5/8	198	7.8	1"	13.4
100mm/4"	352	13-7/8	232	9.1	1"	21
125mm/5"	416	16-3/8	285	9.6	1-1/4"	35.6
150mm/6"	470	18-1/2	305	12.0	1-1/2"	54.2
200mm/8"	543	21-3/8	401	15.8	1-1/2"	100.4
250mm/10"	660	26	473	18.6	2"	141
300mm/12"	770	30-5/16	554	21.8	2"	233